

# R88 DESIGN



Peso medio  
Medium Weight



9010 BT



1013



V05



\*\*\*

## Barra quadra . Square bar

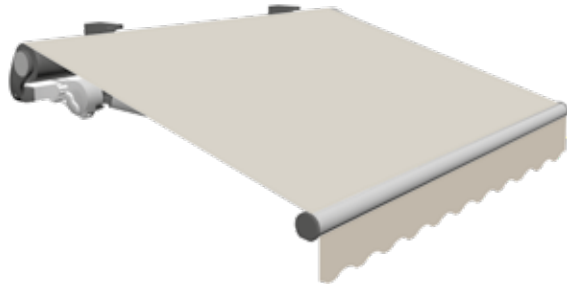

Classe 2

Tenda premontata su barra quadra da 40 x 40 mm, con bracci a pantografo. Design tondo, essenziale e curato, unito ad un'ottima robustezza, rendono la struttura unica e di facile apprezzamento. Elementi strutturali in lega d'alluminio pressofusa. Supporti braccio dotati di un semplificato sistema e regolazione micrometrica. Modello ideale per copertura di balconi, negozi e condomini.

Tenda confezionata: L<6mt. assemblata senza giunzioni (1 collo); 6mt.<L<8mt. pre-assemblata (2/3 colli: rullo, terminale, telo + barra quadra, bracci) senza giunzioni; L>8mt. pre-assemblata (>3 colli: rullo, terminale con giunti + telo + barra quadra con giunti, bracci) con giunzione.

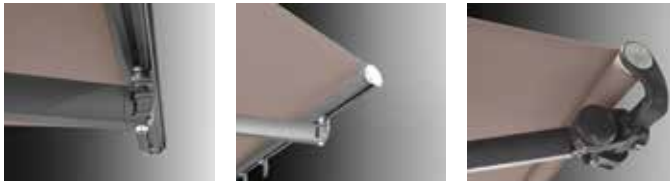

Pre-assembled structure on square bar 40x40 mm with articulated arms. Round design, essential but cared at the time same, together with a good strength, make this structure easily appreciable. The structural elements are in die-casted aluminium; the arm supports are endowed with a simplified micrometric system. Ideal covering for balconies, shops and condominal supplies.

Packaged awning: L<6m. assembled without joints (1 package); 6m.<L<8m. pre-assembled (2/3 packages: roller, terminal, sheet + square bar, arms) without joints; L>8m. pre-assembled (>3 packages: roller, terminal with joints + sheet + square bar with joints, arms) with joint.

### Attacco a parete . Wall application

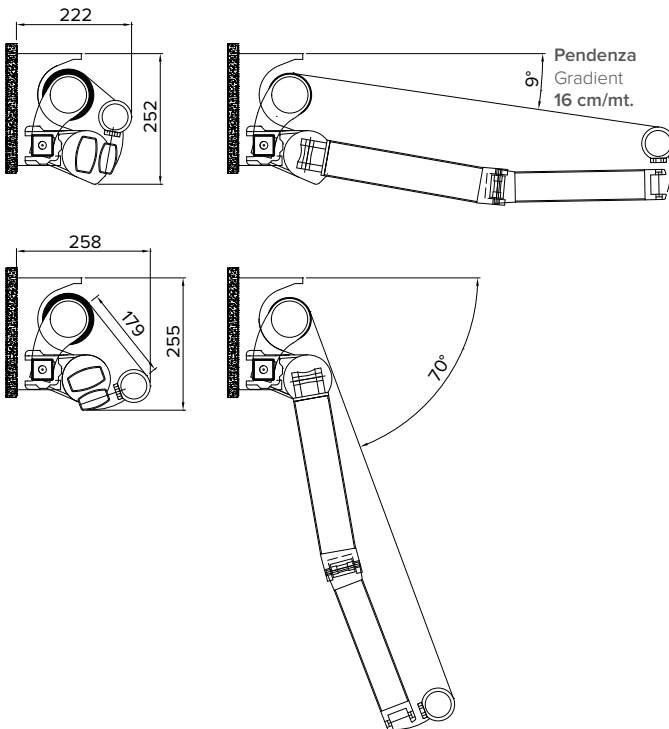

### Attacco a soffitto . Ceiling application

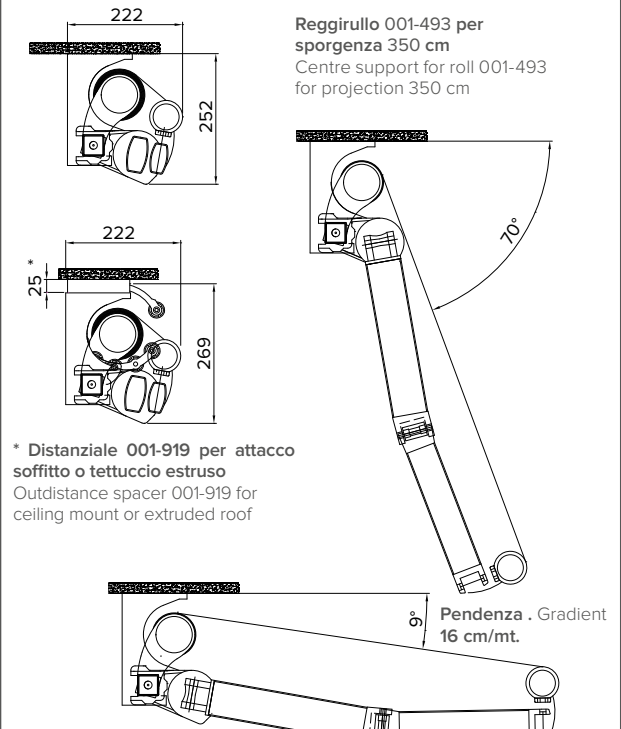

## Optional



+ 20%



+ 5%  
(max L4.5xS2.4)  
No Oscurante  
No Opatex



+ 12%  
Resinati  
(max L4.5xS2.4)



+ 7%  
(max L4.5xS2.4)



+ 20%  
(max L3xS2.2)



Mod. 3  
art. 027-901  
+ 027-902